

See Drawing Drive Adapter

Part 23.1.12 - Nylon-Insert Locknut 1 ea. 3/8

Part 23.2.1 - Washer 1 ea. 3/8

Part 23.2.2 - Round Bar 1 ea. 1/4 Dia. x 6-1/4

Part 23.2.3 - V-Idler Pulley 1 ea. Stens No. 280-255

Part 23.2.4 - Spacer 1 ea. 2-1/8 ODx 1-3/4 IDx3/4

Part 23.2.5 - Friction-Disc 1 ea. Jack's Small Engine No. 7600135YP

Part 23.2.6 - Lockwasher 4 ea. 5/16

Part 23.2.7 - Socket Cap Bolt 5 ea. 5/16-18 x 3/4

Part 23.2.8 - Jam Nut 1 ea. 3/8-16

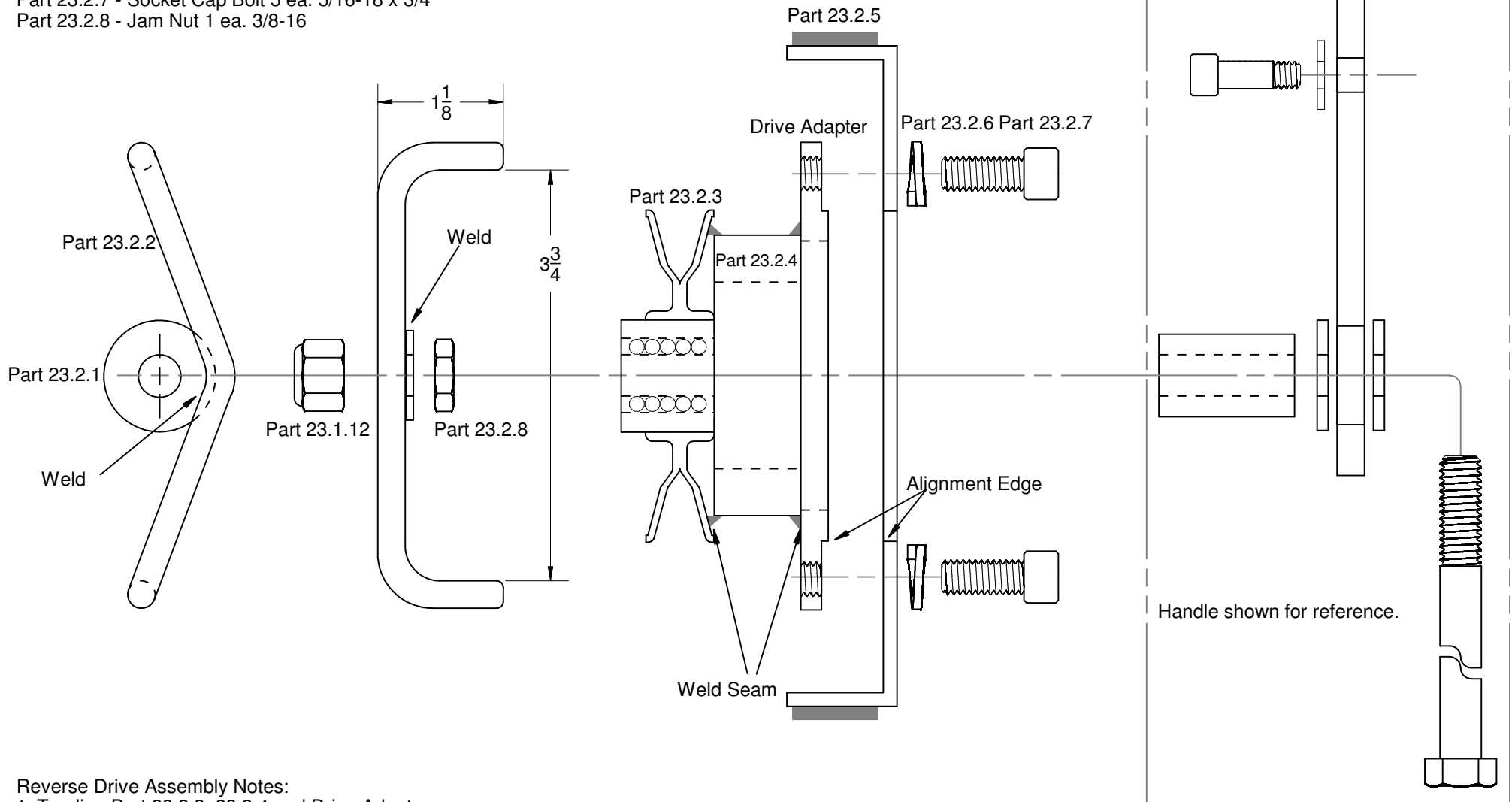

Reverse Drive Assembly Notes:

1. To align Part 23.2.3, 23.2.4 and Drive Adapter together before welding slip 3/8 bolt thru parts and secure with nut. Stitch weld with care.
3. Bend Part 23.2.2 as shown in drawing.