

Part 23.2.9 - Round Flat 1 ea. 4-1/4 Dia. x 1/4

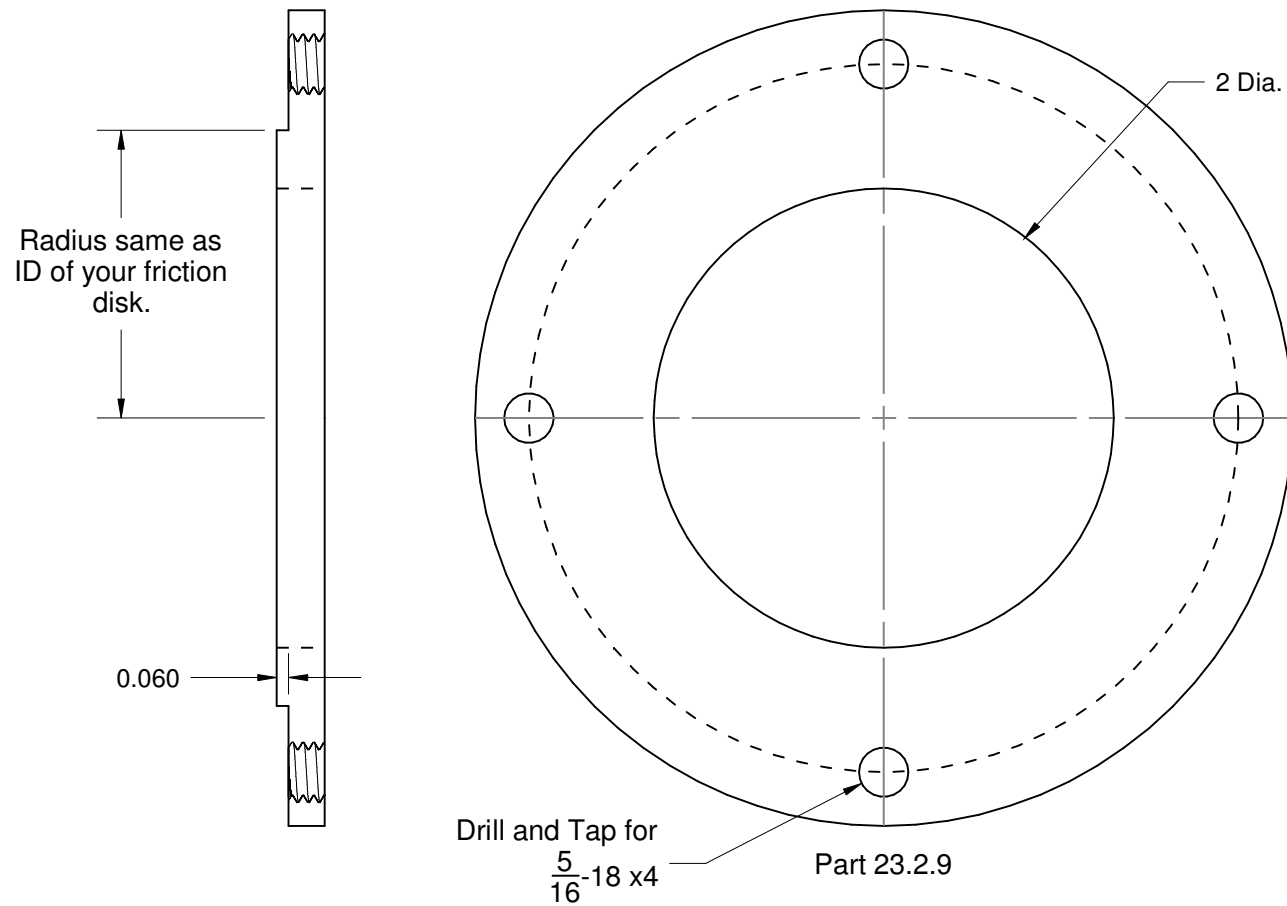

Reverse Drive Adapter Notes:

1. The machining of the adapter is dependent upon the dimensions of the friction disk, Part 23.2.5, that you use. Many sizes are available.
2. The face of this adapter is turned such that an edge (or step) radius is the same as the ID of the friction disk.
3. Take care welding to not warp parts.
4. To locate the 4 holes to drill and tap clamp adapter to friction disk and mark the holes location.